

PSA Straight Plug, Half Moon, Cable Collet (Multipole)

- Connector series: PSA
- Contact: Hermaphroditic
- Locking type: Self-locking
- Orientation type: Straight
- Part No.: PSA.XS.30X. CLACXX
- Mated with: FSA series

Note: "X" refers to part number definition on page 81

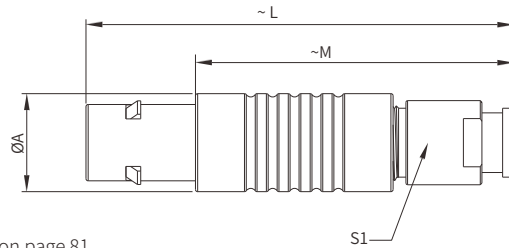

General Information

Ambient temperature:	-55°C~+250°C
Mating endurance:	>5000 cycles
Insulator:	PEEK
Housing:	Brass with gold plated
Connector contacts:	Brass with nickel plated

Insulation resistance:	≥ 100MΩ
IP rating:	IP 50
Shielding efficiency:	at 10MHz>75dB / at 1GHz>40dB
Salt spray corrosion test:	>144h

Size	Dimensions(mm)			
	A	L	M	S1
0S	9.0	34.5	24.5	6.5
1S	12.0	42.5	31.5	8.5
2S	14.8	52.0	40.0	11.0

FSA Fixed Socket, Half Moon, Nut Fixing (Multipole)

- Connector series: FSA
- Contact: Hermaphroditic
- Locking type: Self-locking
- Orientation type: Straight
- Part No.: FSA.XS.30X. CLL
- Mated with: PSA series

Note: "X" refers to part number definition on page 81

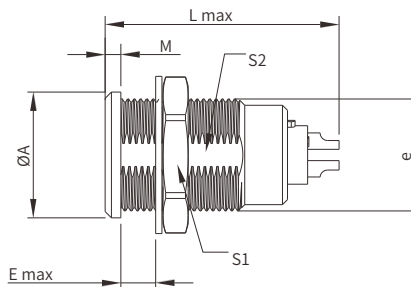

General Information

Ambient temperature:	-55°C~+250°C
Mating endurance:	>5000 cycles
Insulator:	PEEK
Housing:	Brass with gold plated
Connector contacts:	Brass with nickel plated

Insulation resistance:	≥ 100MΩ
IP rating:	IP 50
Shielding efficiency:	at 10MHz>75dB / at 1GHz>40dB
Salt spray corrosion test:	>144h

Size	Dimensions(mm)					
	A	M	S1	S2	e	E
0S	10.0	1.2	11.0	8.2	M9*0.6	7.0
1S	14.0	1.5	14.0	10.5	M12*1.0	7.5
2S	18.0	1.8	17.0	13.5	M15*1.0	8.5

Note: Panel cut-out (page 164)